



## High Level to Low Level Converter (HLC)

Download Manuals

<http://manual.blueeyes.com.tw>

### Occasion to use HLC

- (1) There is no output terminal on horn
- (2) Audio noise from horn
- (3) Horn is too far from iCam but near loudspeaker

### Diagram

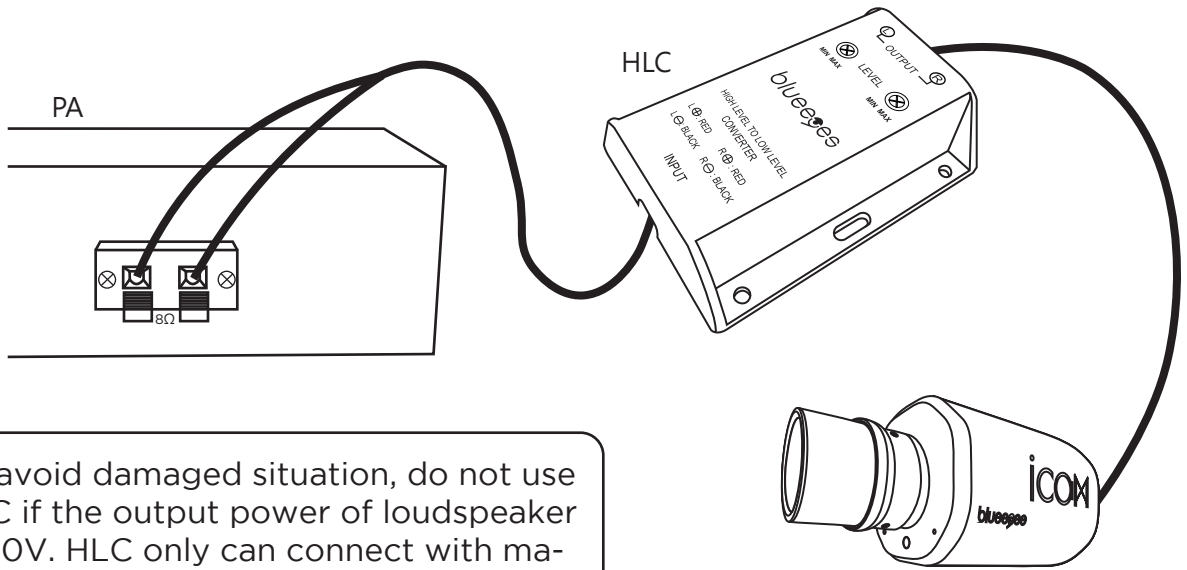

**!** To avoid damaged situation, do not use HLC if the output power of loudspeaker is 110V. HLC only can connect with machine which output is 8Ω or 16Ω. therefore, we recommend you check if there is 8Ω or 16Ω on loudspeaker or inside transformer

### 連接攝影機

